

**Over Masonry or Foam Sheathing -**

Masonry walls are easily covered, by vertically furring the walls and applying nailing strips (1" x 3" or 1" x 4") spaced according to the exposure and single/double course product design. When installing over masonry, the nailing strips should be fastened with special nails, driven between the bricks or blocks, so that the outer shingled wall will be firmly attached.

When installing over foam sheathing, vertical spacers shall be attached with fasteners long enough to penetrate through the foam sheathing and the underlying wood sheathing. Do not apply only to the foam sheathing as it is too weak to provide proper support. (Figure 14).

1" x 3" or 1" x 4" nailing strips spaced according to exposure of Certi-label® Western Cedar shingles or shakes, regardless of single or double course.

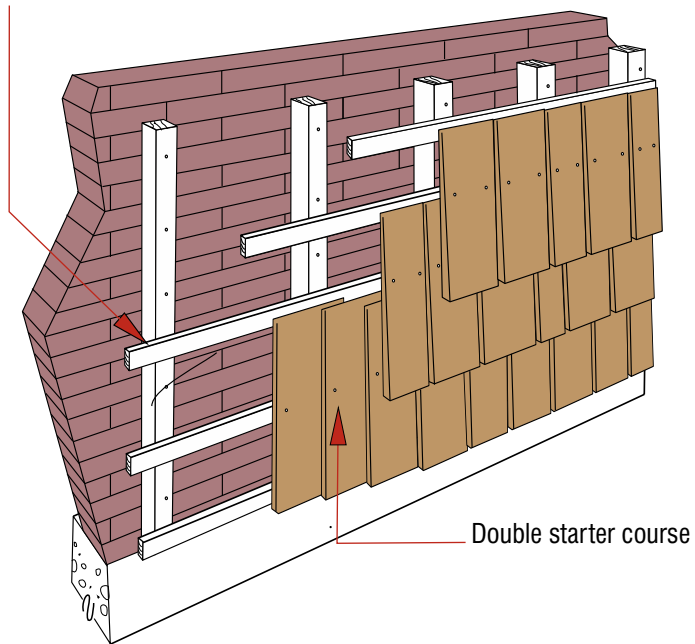

**Figure 14: Over Masonry or Foam Sheathing Detail**

**Over Stucco** - Nailing strips should be attached with nails long enough to penetrate the stucco and the underlying sheathing. Do not apply directly to the stucco, which is too weak to provide a proper support. If the old stucco is removed, new No. 30 felt (ASTM D226 Type II or ASTM D4869 Type IV) underlayment is then applied to the walls, and the shingling can proceed as in new construction (Figure 15).

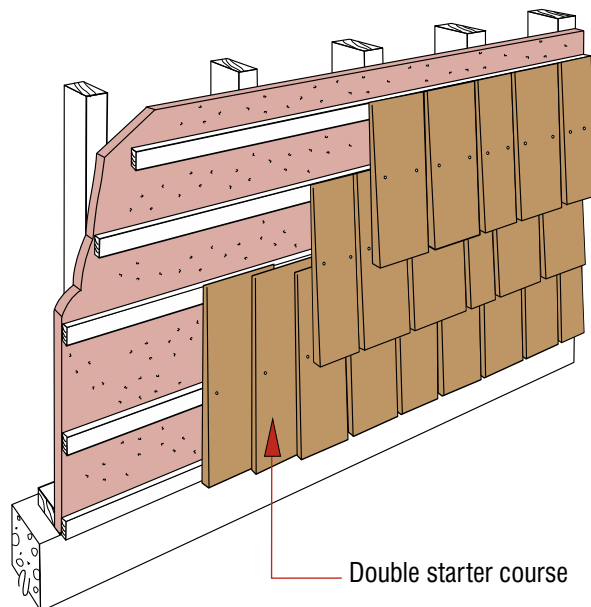

**Figure 15: Over Stucco Detail**