

Figure 2: Spacing Detail

SPACING DETAIL

- Number 1 Grade Certi-label® Western Red Cedar shingles shall be spaced 1/8" to 1/4" apart (keyways are 1/8" to 1/4" wide).
- Number 1 Grade Certi-label® Yellow Cedar shingles shall be spaced 3/16" to 5/16" apart (keyways are 3/16" to 5/16" wide).
- These joints allow for expansion and prevent possible "buckling." For every 4" width of dry Certi-label® Western Cedar shingle material, the product will expand approximately 1/8". Therefore space keyways accordingly, i.e. 12" shingle is expected to have approximately 3/8" expansion.
- Allow minimum 1/4" to 3/8" keyway spacing for Number 2 Grade Rebutted and Rejointed Certi-label® Western Red Cedar shingles.
- Leave a side lap of at least 1 1/2" between joints in adjacent courses.

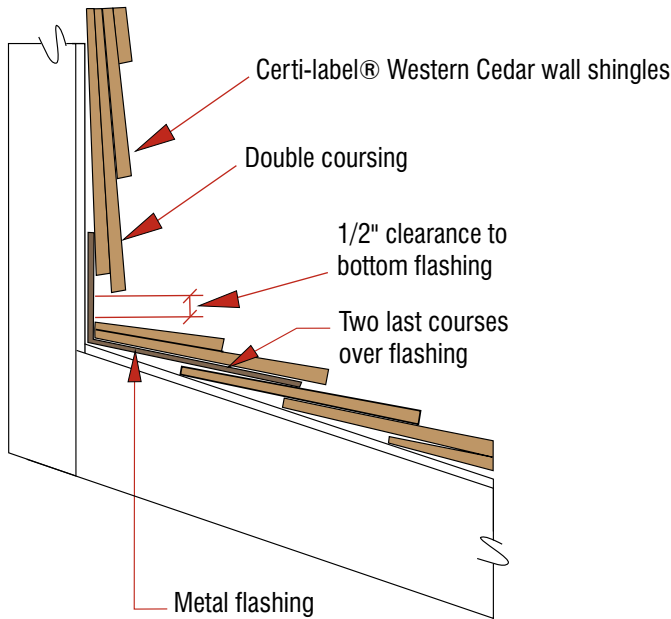

Figure 3a: Flashing

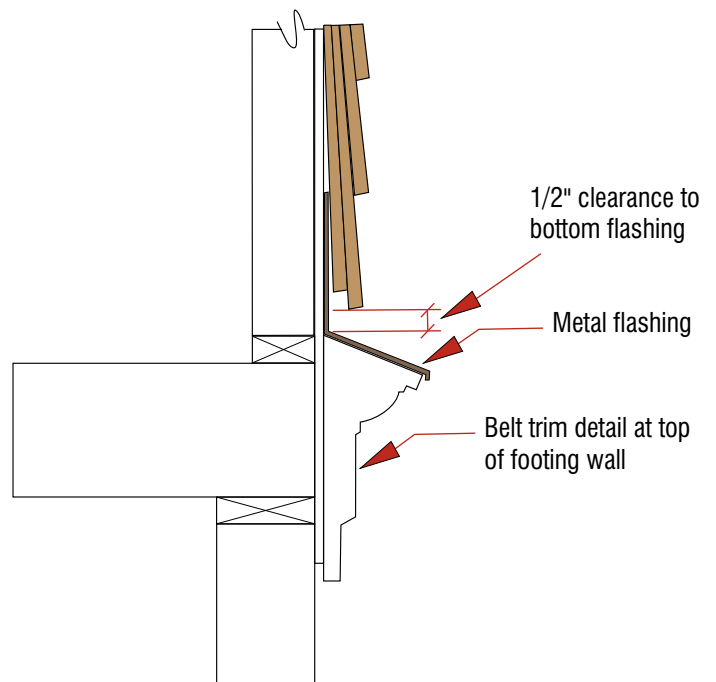

Figure 3b: Flashing

Figures 3a and 3b: To prevent the wicking of water, which may cause staining, keep a 1/2" clearance between the first course of Certi-label® products from all surfaces below.