

## Design and Application Instructions

### Staggered Butt Coursing

For single course application, an attractive effect can be made by staggering the butt of the Certi-label Western Cedar shingle from the horizontal line. Apply the Certi-label Western Cedar shingle irregularly at variable distances below (but not above) the horizontal line.

Staggered butt applications are made by shortening the exposure less than the greater maximum exposure. No Certi-label Western Cedar shingles or shakes shall be applied greater than the maximum exposure allowed. Check with local building codes for approval of the staggered butt coursing installation method.

Note: Keyway spacing-between Number 1 Grade Certi-label Western Red Cedar shingles shall be 3mm – 6mm; Yellow Cedar shingles shall be 6mm - 16mm.

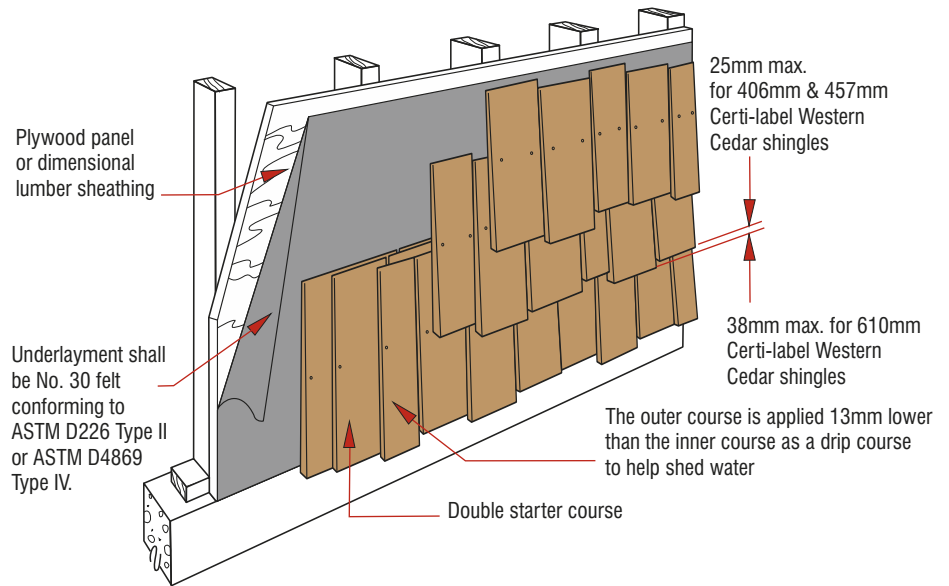

**Figure 10: Staggered Coursing**



Architect: Alfredo De Vido Associates, Photo: Paul Warchol

Butt nail all double coursed Certi-label Western Cedar shingles that are exposed more than their maximum single course exposure.

### Ribbon Coursing

A double shadow line effect can be obtained by raising the outer course Certi-label Western Cedar shingles approximately 25mm above the undercoursing. Use Number 1 Grade Certi-label Western Cedar shingles for undercoursing when applying ribbon coursing (Figure 11).

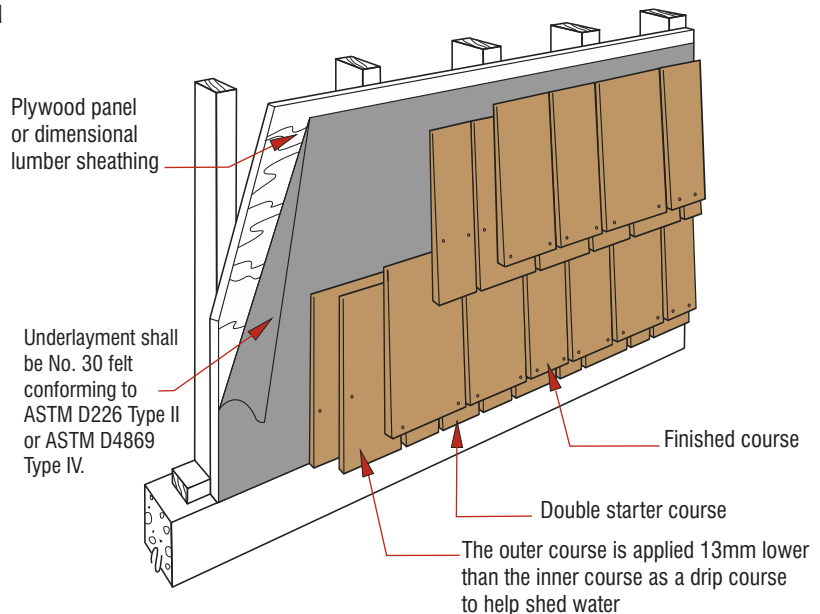

**Figure 11: Ribbon Coursing**