

**Single Coursing**

Double the starting course at the base of the wall (Figure 6). Apply with 3mm to 6mm keyway space between Certi-label Western Cedar shingles, giving a pronounced individual effect to each course.

Offset the side joints in any one course at least 38mm over joints in adjacent courses (Figure 2).

Use a straight edge, nailing it lightly to the wall with the edge at the butt line (to keep courses straight and level). Check for level every 3 or 4 courses.

This wall application features concealed nailing (Figure 6), with nails driven approximately 25mm above the butt line of the succeeding course. For Certi-label Western Cedar shingles up to 254mm wide, place two nails in each shingle 19mm from each edge. With Certi-label Western Cedar shingles wider than 254mm, drive two additional nails approximately 25mm apart near the center.

Because Certi-label Western Cedar shingles vary in width there should be little waste. At corners, or at door or window frames, you may have to trim a selected Certi-label Western Cedar shingle slightly.

The CSSB recommends installing over plywood panel or dimensional lumber sheathing. If other sheathing materials are approved for use by your local building official, the holding power of the fasteners should also be considered carefully.

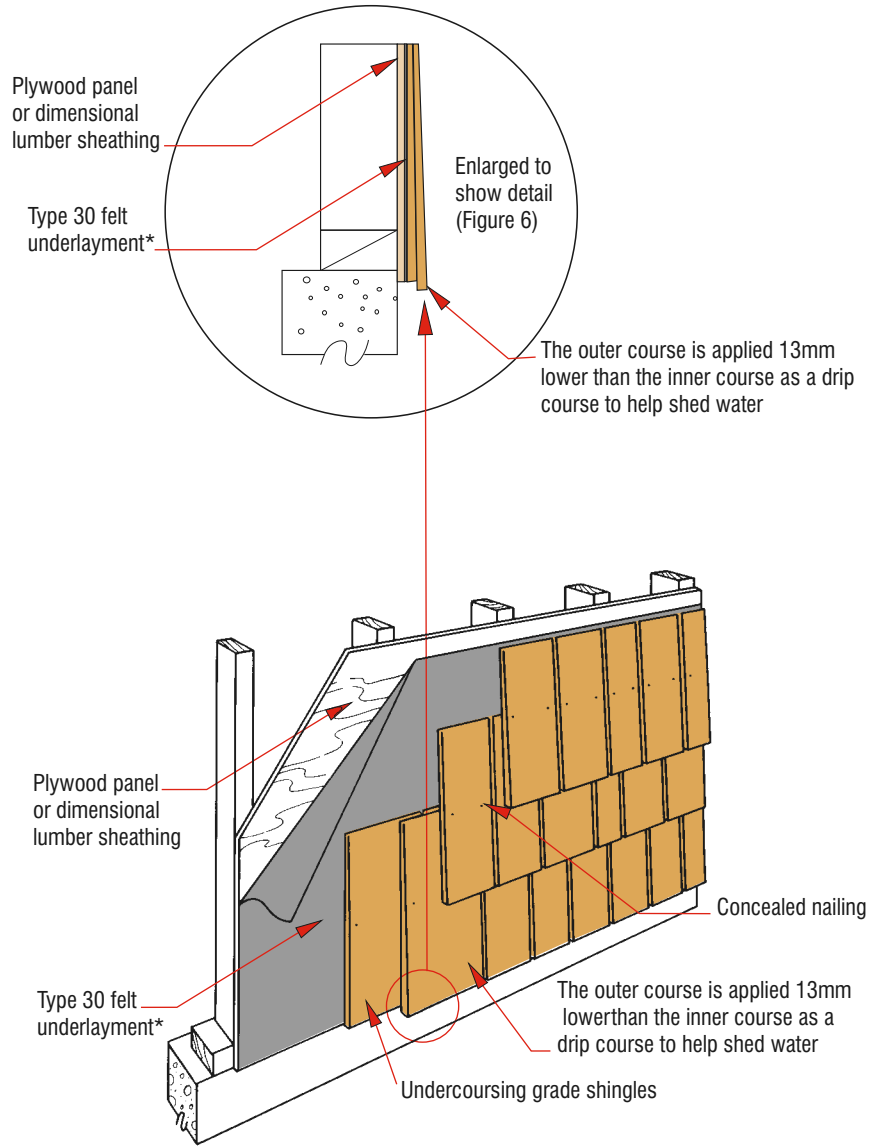

\*The Cedar Bureau recommends Type 30 ASTM Designation 226 (ASTM D226) or ASTM Designation 4869 (ASTM 4869) felt underlayment and will refer to required underlayment as Type 30 throughout this manual. Check with your local building official for any questions about alternative underlayment materials.

**Figure 6: Single Coursing**



Architect: Shope Reno Wharton, Photo: Robert Benson